



## Standard Features:

- **ComfortRest®** - Provides continuous leg support when reclined.
- **EasyOff Backs** - Removable back for easier delivery and moving from room to room.
- **Lighted Cupholder** - generously sized to hold most cans, bottles and drink cups. Lighted ring illuminates the cupholder from the inside.
- **Ambient Base Lighting** - Soft glowing light illuminates from the bottom of the chair giving the ambience of an actual movie theater.

## Optional Features:

- **ButtKicker®** - Silent subwoofer in seat that allows viewers to feel powerful bass without excessive volume.
- **Wallaway®** - Fully reclines just inches away from the wall, allowing greater decorating flexibility and more efficient use of space.
- **TouchMotion®** - Easily reclines at the touch of a button.
- **PowerRecline®** - Effortlessly recline to your favorite position.



## STRAIGHT

**3900** - Straight Arm RF/LF, WAW®, TM®, Rec  
**3901** - Straight Arm RF/LF, WAW®, PR®, Rec  
**H. 43" W. 39.25" SD. 22.5" OD. 38.5"**

**5200** - Straight Arm RF, WAW®, TM®, Rec  
**5201** - Straight Arm RF, WAW®, PR®, Rec  
**H. 43" W. 32.5" SD. 22.5" OD. 38.5"**

**5300** - Straight Arm LF, WAW®, TM®, Rec  
**5301** - Straight Arm LF, WAW®, PR®, Rec  
**H. 43" W. 32.5" SD. 22.5" OD. 38.5"**

**5400** - Armless, WAW®, TM®, Rec  
**5401** - Armless, WAW®, PR®, Rec  
**H. 43" W. 25.75" SD. 22.5" OD. 38.5"**

## CURVED

**5240** - LF Wedge Arm/RF Straight Arm, WAW®, TM®, Rec  
**5241** - LF Wedge Arm/RF Straight Arm, WAW®, PR®, Rec  
**H. 43" W. 42.25" SD. 22.5" OD. 38.5"**

**5340** - Wedge Arm RF/LF Straight Arm, WAW®, TM®, Rec  
**5341** - Wedge Arm RF/LF Straight Arm, WAW®, PR®, Rec  
**H. 43" W. 42.25" SD. 22.5" OD. 38.5"**

**5440** - Wedge Arm RF, WAW®, TM®, Rec  
**5441** - Wedge Arm RF, WAW®, PR®, Rec  
**H. 43" W. 35.5" SD. 22.5" OD. 38.5"**

Available in fabric, suede, vinyl, 100% genuine top grain leather or LeatherPlus.\*

\* LeatherPlus combines leather and vinyl for value and comfort.

WAW® = Wallaway®

TM® = TouchMotion®

PR® = PowerRecline®

REC = Recliner

©2008 Berkline, LLC

Specifications accurate at time of printing.

Specifications are subject to change without notification.

Revised 4/08.

## 43" BACK HEIGHT

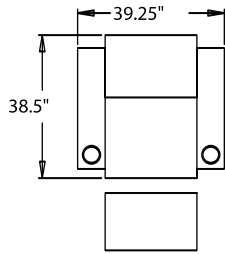

3900 RECLINER  
3901 POWER

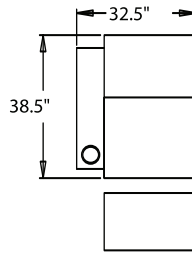

5300 LF ARM  
RECLINER  
5301 LF ARM  
POWER

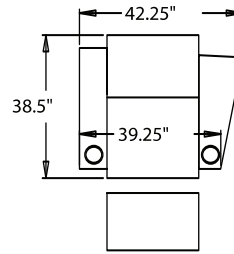

5340 LF ARM  
CONSOLE RF  
5341  
POWER

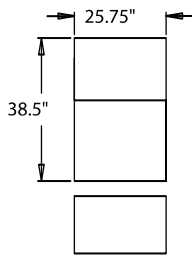

5400 ARMLESS  
RECLINER  
5401 ARMLESS  
POWER

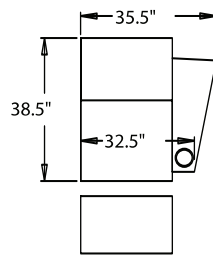

5440  
CONSOLE RF  
5441  
POWER

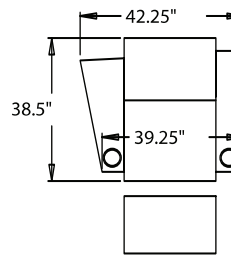

5240 RF ARM  
CONSOLE LF  
5241  
POWER

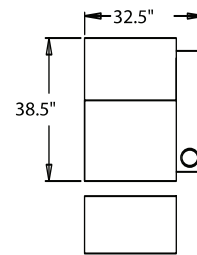

5200 RF ARM  
RECLINER  
5201 RF ARM  
POWER

