



## Standard Features:

- **Boxed Pillow Top Seating** - Finished with generously padded box cushions and topped with a plush pillow of soft padding for added comfort.
- **ComfortRest®** - Provides continuous leg support when reclined.
- **Wallaway®** - Fully reclines with only inches of wall clearance.
- **EasyOff Backs** - Removable back for easier delivery and moving from room to room.

## Optional Features:

- **Mini ButtKicker®** - Silent subwoofer in seat that allows viewers to feel powerful bass without excessive volume.
- **Lighted Cupholder** - Generously sized to hold most cans, bottles and drink cups. Lighted ring illuminates the cupholder from the inside.
- **TouchMotion®** - Easily reclines at the touch of a button.
- **PowerRecline®** - Effortlessly recline to your favorite position.

## STRAIGHT

**3900** - Straight Arm RF/LF, WAW®, TM®, Rec  
**3901** - Straight Arm RF/LF, WAW®, PR®, Rec  
**H. 41.5" W. 34" SD. 22" OD. 37.5"**

**5200** - Straight Arm RF, WAW®, TM®, Rec  
**5201** - Straight Arm RF, WAW®, PR®, Rec  
**H. 41.5" W. 28.75" SD. 22" OD. 37.5"**

**5300** - Straight Arm LF, WAW®, TM®, Rec  
**5301** - Straight Arm LF, WAW®, PR®, Rec  
**H. 41.5" W. 28.75" SD. 22" OD. 37.5"**

**5400** - Armless, WAW®, TM®, Rec  
**5401** - Armless, WAW®, PR®, Rec  
**H. 41.5" W. 23.5" SD. 22" OD. 37.5"**

## CURVED

**5240** - LF Wedge Arm/RF Straight Arm, WAW®, TM®, Rec  
**5241** - LF Wedge Arm/RF Straight Arm, WAW®, PR®, Rec  
**H. 41.5" W. 36.75" SD. 22" OD. 37.5"**

**5340** - Wedge Arm RF/LF Straight Arm, WAW®, TM®, Rec  
**5341** - Wedge Arm RF/LF Straight Arm, WAW®, PR®, Rec  
**H. 41.5" W. 36.75" SD. 22" OD. 37.5"**

**5440** - Wedge Arm RF, WAW®, TM®, Rec  
**5441** - Wedge Arm RF, WAW®, PR®, Rec  
**H. 41.5" W. 31.5" SD. 22" OD. 37.5"**

Available in fabric, suede, vinyl, 100% genuine top grain leather or LeatherPlus.\*

\* LeatherPlus combines leather and vinyl for value and comfort.

©2008 Berkline, LLC  
 Specifications accurate at time of printing.  
 Specifications are subject to change without notification.  
 Revised 5/08.

WAW® = Wallaway®  
 TM® = TouchMotion®  
 PR® = PowerRecline®  
 REC = Recliner



## 45004

41.5" BACK HEIGHT ON ALL PIECES

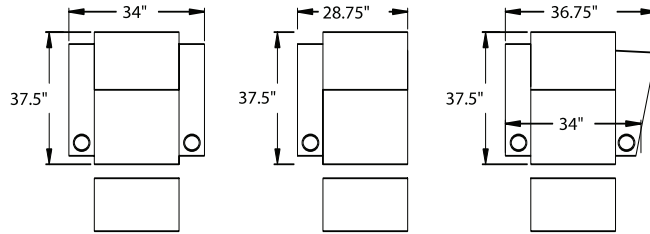

3900 RECLINER  
3901 POWER

5300 LF ARM  
RECLINER  
5301 LF ARM  
POWER

5340 LF ARM  
CONSOLE RF  
5341  
POWER

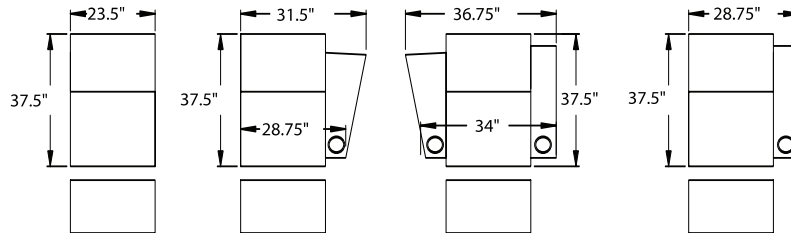

5400 ARMLESS  
RECLINER  
5401 ARMLESS  
POWER

5440  
CONSOLE RF  
5441  
POWER

5240 LF ARM  
CONSOLE RF  
5241  
POWER

5200 RF ARM  
RECLINER  
5201 RF ARM  
POWER

